

Limited Liability

These warranties replace all other warranties, expressed or implied including, but not limited to, the implied warranties of merchantability and fitness for a particular purpose.

Thermaltake disclaims all other warranties, expressed or implied including, without limitation, implied warranties of merchantability and fitness for a particular purpose.

Some jurisdictions do not allow the exclusion of implied warranties so this limitation may not apply to you. All expressed and implied warranties are limited in duration to the limited warranty period. No warranties apply after that period, some jurisdiction do not allow limitation on how long an implied warranty lasts, so this limitation may not apply to you.

Limitations of liability, Thermaltake's responsibility under this, or any other warranty, implied or expressed, are limited to repair or replacement, as set forth above. These remedies are the sole and exclusive remedies for any breach of warranty. Thermaltake is not responsible for direct, special, incidental, or consequential damages resulting from any breach of warranty or under any other legal theory including, but not limited to, lost profits, downtime, goodwill, damage to or replacement of equipment and property, and any cost of recovering, reprogramming, or reproducing any program or data stored in or used with a system containing Thermaltake product. Some jurisdictions do not allow the exclusion or limitation of incidental or exclusions may not apply to you.

Extent of limited warranty, Thermaltake does not warrant that your product will be free from design defects or errors known as "ERRATA". Current characterized errata are available upon request. This limited warranty does not cover any costs relating to removal or replacement of any part that is soldered or otherwise affixed to your system's motherboard. This limited warranty does not cover damages due to external causes, including accidental, problems with electrical power, usage not in accordance with product instructions, misuse, neglect, alteration, repair, improper installation, or improper testing. Nor is Thermaltake held liable for any bodily damage that may result during the installation, maintenance, repair, or is otherwise associated with this product, Thermaltake is free from any legal actions that may result in death, pain and anguish, or any other form of personal damage that may occur by purchasing this product.

You, the buyer, agree to this warranty and its term set within its expressed and implied limited warranty. This limited warranty gives you specific legal rights, and you may also have other right that varies from jurisdiction to jurisdiction.

CAUTION

Before installing Thermaltake Water2.0 Extreme Liquid Cooling System, we strongly suggest you to read the manual thoroughly and make sure all components are included in the package. Please do follow the installation guide step-by-step.

Improper installation may cause serious damage to the system as well as to the water cooling unit. Thermaltake will not responsible for any damages due to incorrect installation and incorrect usage of this product.

Specification

Compatibility (CPU Socket)		Intel LGA 2011/1366/1155/1156/775 AMD FM1/AM3+/AM3/AM2+/AM2
Water Block	Material	Copper
Pump	Motor Speed	2800±150 RPM
	Rated Voltage	12V
	Rated Current	220 mA
Fan	Dimension	120 x 120 x 25 mm
	Speed	1200~2000RPM
	Noise Level	27.36dBA(Max)
	Rated Voltage	12V
	Rated Current	0.5 A
	Max. Air Flow	81.32CFM
	Connector	4 Pin
Radiator	Dimension	270 x 120 x 38.3mm
	Material	Aluminum
Tube	Length	326 mm
	Material	Rubber
Weight		1,150g

Components

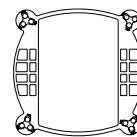

A Back Plate x 1 (Intel 1366/1156/1155/775)

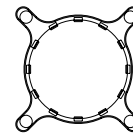

B Retention Ring x 1 (Intel 2011/1366/1156/1155/775)

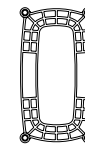

C Back Plate x 1 (AMD)

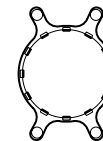

D Retention Ring x 1 (AMD)



E Mylar x 2



F Grommet x 4



G Screw x 8 (for fan)



H Plastic component x 4



I Plastic component x 4

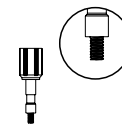

J Screw x 4 (Intel 1366/1156/1155/775 & AMD)

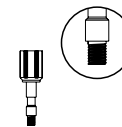

K Screw x 4 (Intel 2011)

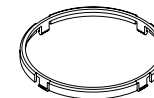

L Retention clip x 1



M Washer x 4



N Screw x 4 (for radiator)



O CD x 1

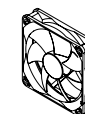

P Fan x 2

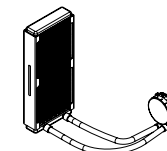

Q Water 2.0 Extreme Unit x 1

Installation steps

In order to ensure convenience and safety , following the installation procedure below is strongly recommended.

Components Check



Pump Installation

Intel LGA 2011	P1.
Intel LGA 1366/1156/1155/775	P2.
AMD FM1/AM3+/AM3/AM2+/AM2	P3.



Install Radiator P4.



Fan and Pump Connection P5.



Software Installation P5.



Installation Complete

Pump Installation

For Intel LGA 2011

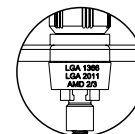
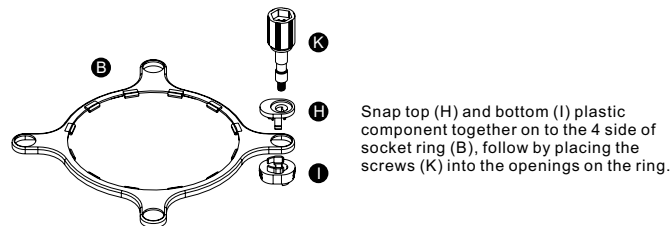

Note:
The letters LGA2011
must be seen when
snapping the bottom (I)

**** Please remove the transparent cap in front of the pump when installing on to the CPU, and be careful not to touch the thermal paste.**

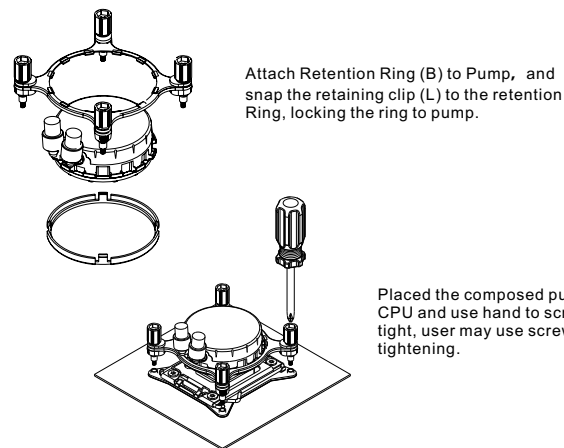

Placed the composed pump on to the CPU and use hand to screw (K) until its tight, user may use screw driver for tightening.

Pump Installation

For Intel LGA 1366/1156/1155/775

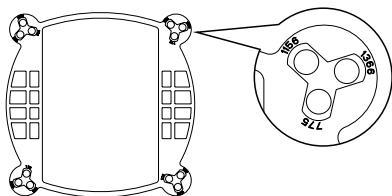

Please check the socket type match CPU and choose the right opening to place (A) into it.

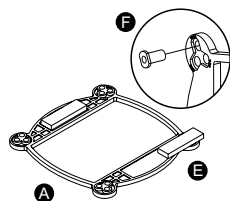

Stick Mylar(E) on the back of the (A) and place the four grommets (F) on to the corresponding openings.

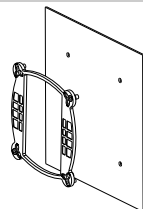

Stick the composed Back Plate (A) on to the back of the motherboard.

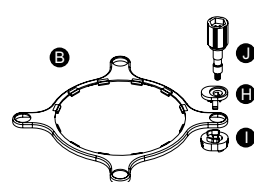

Snap top (H) and bottom (I) plastic component together on to the 4 side of socket ring (B), follow by placing the screws (J) into the openings on the ring.

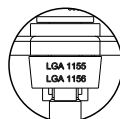

Notice:
The letters of the socket must be seen when snapping the bottom (I)

**** Please remove the transparent cap in front of the pump when installing on to the CPU, and be careful not to touch the thermal paste.**

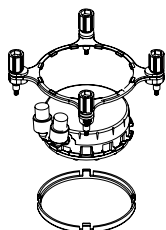

Attach Retention Ring (B) to Pump, and snap the retaining clip (L) to the retention Ring, locking the ring to pump.

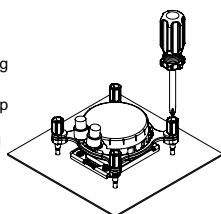

Placed the composed pump on to the CPU and use hand to screw (J) until its tight, user may use screw driver for tightening.

Pump Installation

For AMD FM1/AM3+/AM3/AM2+/AM2

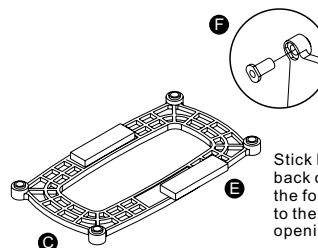

Stick Mylar(E) on the back of the (C) and place the four grommets (F) on to the corresponding openings.

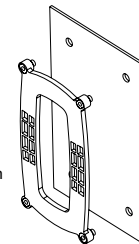

Stick the composed Back Plate (C) on to the back of the motherboard.

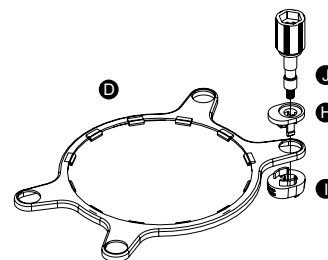

Snap top (H) and bottom (I) plastic component together on to the 4 side of socket ring (D), follow by placing the screws (J) into the openings on the ring.



Notice:
The letters AMD2/3 must be seen when snapping the bottom (I)

**** Please remove the transparent cap in front of the pump when installing on to the CPU, and be careful not to touch the thermal paste.**

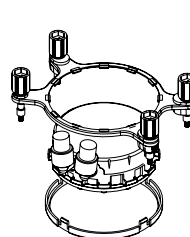

Attach Retention Ring (D) to Pump, and snap the retaining clip (L) to the retention Ring, locking the ring to pump.

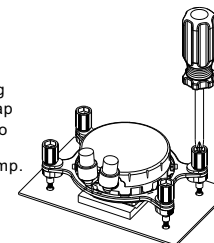

Placed the composed pump on to the CPU and use hand to screw (J) until its tight, user may use screw driver for tightening.

Radiator Installation

Mount the Radiator and Fan on to the Chassis.

Note : Notice the airflow direction (As the photo illustrates).

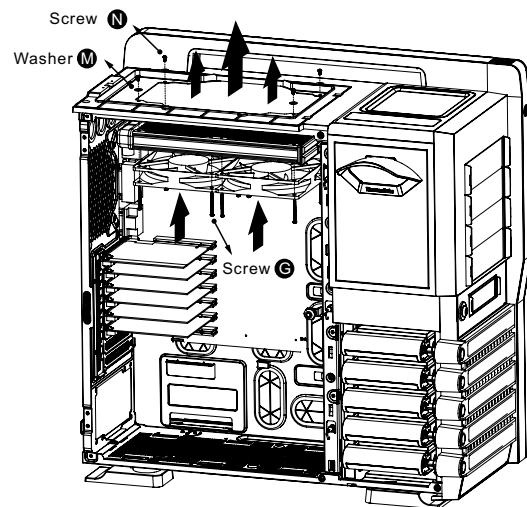

Connect the Fan and Pump

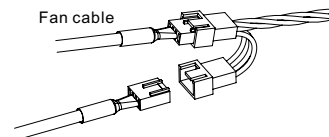

Connect the fans to pump fan output cable.

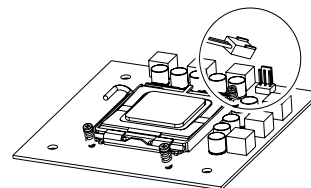

Connect the Pump Power Cable onto nearest CPU fan header of motherboard.

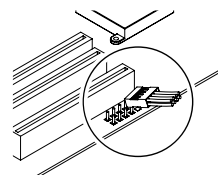

Connect USB cable to motherboard.

Software Installation

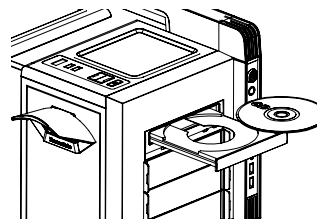

Install software.